

CHILD RESTRAINT SYSTEM INFORMATION

MODEL **AY939-A (i-Size 360)**

GROUP **40cm -135cm**

BRAND **CROLLA**



0090468

UNR TESTING INFORMATION

Regulation	ECE R44/04
Approval Number	E8*129R03/04*12777*00
CTA Reference Number	JPJ.BKA.600-3/3/33 Jld 233 (50)
CTA Approval Date	31 OCTOBER 2022

INSTALLATION TYPE

Installation Type/ Direction	Seatbelt	ISOFIX	Top Tether	Support Leg
Rear Facing	N/A	✓	N/A	✓
Forward Facing	N/A	✓	N/A	✓

PHOTOS

	Front view	Left view	Rear view	Right view
Rear Facing				
Forward Facing				

CHILD RESTRAINT SYSTEM INFORMATION

COLOUR VARIANT



Tiffany Blue



Neon Orange

INSTALLATION

Group

Installation Method

4.1 Installing the rear facing position



Child height : newborn - 105cm
Usage : ISOFIX & Support Leg

! DO NOT use forward facing before the child's age exceeds 15 months.

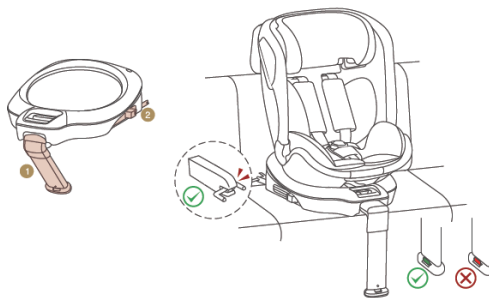

- 1 Pull the support leg from the lower cover of the base (see 3.9);
- 2 Push the ISOFIX connectors until the longest by using the ISOFIX adjuster (see 3.8);
- 3 Install the enhanced child restraint system on the car seat;

14

04
INSTALLATION

0/0+

Newborn – 105cm



- 4 Rotate the seat to make it face the car door, then put your child in the enhanced child restraint system, adjust the shoulder straps and engage the buckle (see 3.3 ~ 3.5);

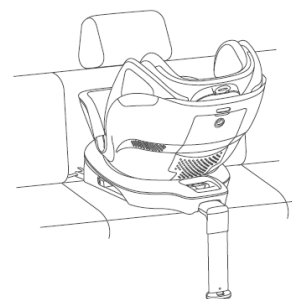

- 5 Lastly, rotate the seat to rear-facing position.

15

CHILD RESTRAINT SYSTEM INFORMATION

1

83cm – 105 cm

4.2 Installing the forward facing position

Child height : 83cm - 105cm

Usage : ISOFIX & Support Leg

PLEASE MAKE SURE YOUR CHILD EXCEEDS 15 MONTHS TO USE FORWARD FACING POSITION.

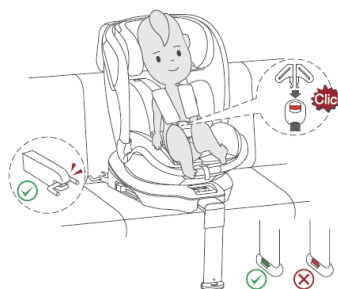

- 1 Pull the support leg from the lower cover of the base (see 3.9);
- 2 Push the ISOFIX connectors until the longest by using the ISOFIX adjuster (see 3.8);
- 3 Install the enhanced child restraint system on the car seat;
- 4 Lastly, put your child in the enhanced child restraint system, adjust the shoulder straps and engage the buckle (see 3.3 ~ 3.5).

16

4.3 Installing the forward facing position

Child height : 105cm - 135cm

Usage 1 : ISOFIX, adult three-point seat belt & support leg.

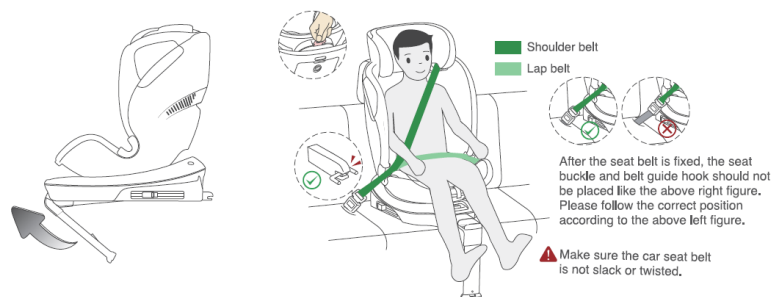

- 1 Pull out the support leg from the lower cover of the base (see 3.9);
- 2 Push the ISOFIX connectors until the longest by using the ISOFIX adjuster (see 3.8);
- 3 Install the enhanced child restraint system on the car seat;
- 4 Put your child in the enhanced child restraint system. Adjust the headrest height according to the child's shoulder height (see 3.2) ;
- 5 According to the installation path, pull the car seat belt across the child's body and passes into the car groove of the enhanced child restraint body part; Make sure that the car seat shoulder belt passes through the guide groove of the headrest, and pull the car seat lap belt to check whether it is locked.

17

OR

Child height : 105cm - 135cm

Usage 2: Adult three-point seat belt.

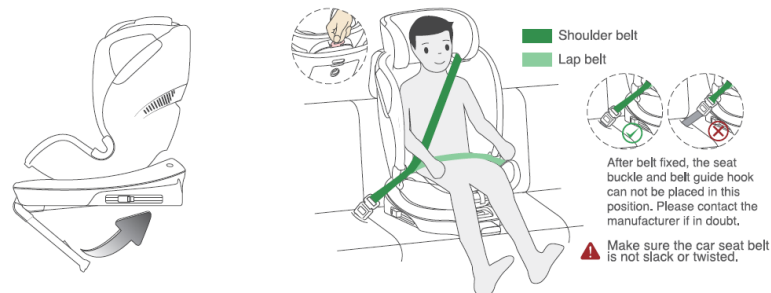

- 1 Put away the support leg (see 3.9)
- 2 Put your child in the enhanced child restraint system. Adjust the headrest height according to the child's shoulder height (see 3.2) ;
- 3 According to the installation path, pull the car seat belt across the child's body and passes into the car groove of the enhanced child restraint body part; Make sure that the car seat shoulder belt passes through the guide groove of the headrest, and pull the car seat lap belt to check whether it is locked.

18



2/3

105cm – 135cm