

CHILD RESTRAINT SYSTEM INFORMATION

MODEL **C1504 (BOLD)**

GROUP **1 / 2 / 3**

BRAND **JOIE**



0260183

UNR TESTING INFORMATION

Regulation	ECE R44/04
Approval Number	E11 44R-041636 Ext 00
CTA Reference Number	JPJ.BKA,600-3/3/33 Jld (56)(16)
CTA Approval Date	16 JANUARY 2020

INSTALLATION TYPE

Installation Type/ Direction	Seatbelt	ISOFIX	Top Tether	Support Leg
Rear Facing	N/A	N/A	N/A	N/A
Forward Facing	✓	✓	✓	N/A

PHOTOS

	Front view	Left view	Rear view	Right view
Rear Facing	N/A	N/A	N/A	N/A
Front Facing				

CHILD RESTRAINT SYSTEM INFORMATION

COLOUR VARIANT

Ember



Deep Sea



INSTALLATION

Group

Installation Method

0/0+
Up to 83cm
0-13kg

N/A

1
71cm and above
9-18kg

Installed forward facing with adult 3-point seat belt and Isofix with Top Tether

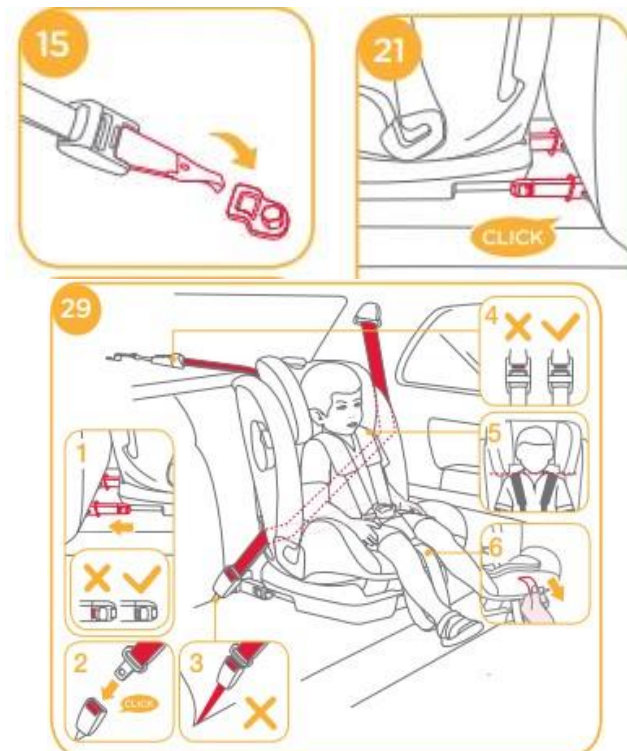

CHILD RESTRAINT SYSTEM INFORMATION

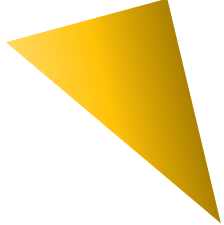

2

100cm and above
15-25kg

Same as for Group 1

Installed forward facing with adult Isofix and Top Tether

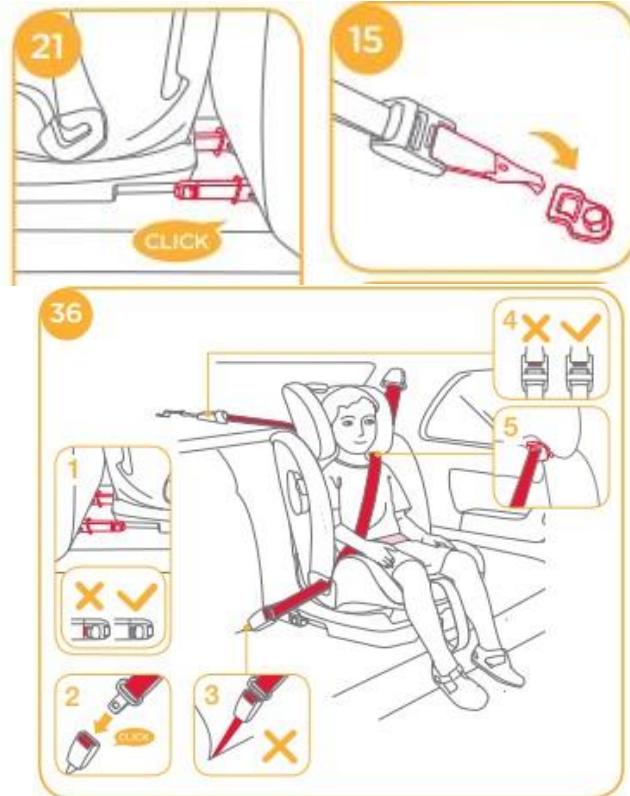

3

Up to 135cm
22-36kg